

RYCO

CODE 62K COUPLINGS



CODE 62K FLANGE COUPLINGS

DIMENSIONS FOR RYCO CODE 62K SPECIAL FLANGES

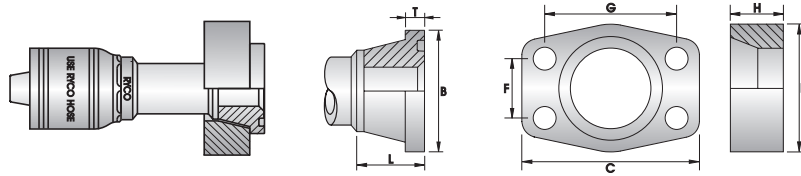

NOM. FLANGE SIZE	DASH SIZE	B	T	L	G	F	C	H	D	BOLT HOLE DIA.									
inch		mm	in	mm	in	mm	in	mm	in	mm	in								
1	-16	49,3	1.94	9,1	0.39	30,0	1.18	57,2	2.25	27,8	1.06	81,0	3.19	26,9	1.06	70,3	2.77	13,0	0.51
1.1/4	-20	53,8	2.12	10,0	0.39	34,3	1.35	66,7	2.63	31,8	1.25	95,9	3.78	32,0	1.26	98,5	3.88	15,2	0.60
1.1/2	-24	68,4	2.69	13,0	0.51	44,7	1.76	79,4	3.13	36,5	1.44	112,5	4.43	39,1	1.54	94,4	3.72	16,9	0.67
2	-32	79,2	3.12	13,0	0.51	55,0	2.17	96,8	3.81	44,5	1.75	133,5	5.23	50,4	1.98	114,3	4.50	20,7	0.81

CODE 62K FLANGE

T6335

T6912

T6445

T6455

SPECIAL FLANGE
RYCO CODE 62K
O RING NOT SUPPLIED

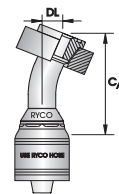
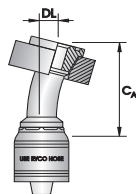
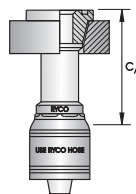

HOSE SIZE		NOM. FLANGE SIZE	DASH SIZE	RYCO CODE 62K FLANGE	RYCO CODE 62K FLANGE 15° TUBE BEND	RYCO CODE 62K FLANGE 22.5° TUBE BEND	RYCO CODE 62K FLANGE 30° TUBE BEND				
DN	inch	inch		PART NO	C _A	PART NO	C _A DL	PART NO	C _A DL	PART NO	C _A DL
25	1	1	-1616	T6335-1616	62	T6912-1616	125 17				
25	1	1.1/4	-1620	T6335-1620	47						
31	1.1/4	1	-2016	T6335-2016	115						
31	1.1/4	1.1/4	-2020	T6335-2020	95					T6455-2020	171 40
31	1.1/4	1.1/2	-2024	T6335-2024	80	T6912-2024	166 18			T6455-2024	166 38
38	1.1/2	1.1/2	-2424	T6335-2424	107	T6912-2424	194 24			T6455-2424	184 50
38	1.1/2	2	-2432	T6335-2432	92	T6912-2432	195 27				
51	2	1.1/2	-3224	T6335-3224	147						
51	2	2	-3232	T6335-3232	122			T6445-3232	219 45	T6455-3232	213 55

CODE 62K FLANGE

T6932

SPECIAL FLANGE
RYCO CODE 62K
O RING NOT SUPPLIED

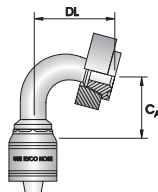

HOSE SIZE		NOM. FLANGE SIZE	DASH SIZE	RYCO CODE 62K FLANGE 90° TUBE BEND		
DN	inch	inch		PART NO	C _A	DL
38	1.1/2	1.1/2	-2424	T6932-2424	99	157

CODE 62K FLANGE

T6100

SPECIAL FLANGE
RYCO CODE 62K
O RING NOT SUPPLIED

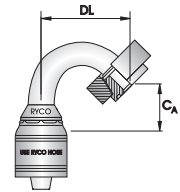

HOSE SIZE		NOM. FLANGE SIZE	DASH SIZE	RYCO CODE 62K FLANGE 135° TUBE BEND		
DN	inch	inch		PART NO	C _A	DL
51	2	2	-3232	T6100-3232	109	242

CODE 62K FLANGE COUPLINGS

CODE 62K FLANGE

T6355

T6359

T6465

T6914

SPECIAL FLANGE
RYCO CODE 62K
O RING NOT SUPPLIED

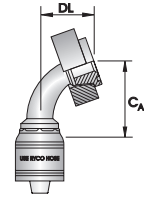
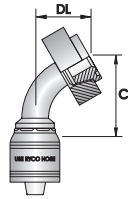

HOSE SIZE			NOM. FLANGE SIZE	DASH SIZE	RYCO CODE 62K FLANGE			RYCO CODE 62K FLANGE 45° LONG TUBE BEND			RYCO CODE 62K FLANGE 60° TUBE BEND			RYCO CODE 62K FLANGE 70° TUBE BEND		
DN	inch	inch			PART NO	C _A	DL	PART NO	C _A	DL	PART NO	C _A	DL	PART NO	C _A	DL
25	1	1	-1616		T6355-1616	108	50							T6914-1616	115	70
25	1	1.1/4	-1620		T6355-1620	107	50									
31	1.1/4	1	-2016		T6355-2016	153	55									
31	1.1/4	1.1/4	-2020		T6355-2020	158	60	T6359-2020						T6914-2020	169	96
31	1.1/4	1.1/2	-2024		T6355-2024	168	60									
38	1.1/2	1.1/4	-2420		T6355-2420	158	73									
38	1.1/2	1.1/2	-2424		T6355-2424	167	80				T6465-2424	200	94			
38	1.1/2	2	-2432		T6355-2432	158	95									
51	2	1.1/2	-3224		T6355-3224											
51	2	2	-3232		T6355-3232	193	90	T6359-3232	248	135	T6465-3232	241	120			

CODE 62K FLANGE

T6916

T6918

T6375

T6936

SPECIAL FLANGE
RYCO CODE 62K
O RING NOT SUPPLIED

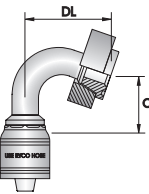
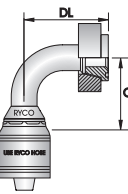
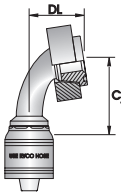
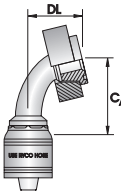

HOSE SIZE			NOM. FLANGE SIZE	DASH SIZE	RYCO CODE 62K FLANGE 75° TUBE BEND			RYCO CODE 62K FLANGE 80° TUBE BEND			RYCO CODE 62K FLANGE 90° TUBE BEND			RYCO CODE 62K FLANGE 100° TUBE BEND		
DN	inch	inch			PART NO	C _A	DL	PART NO	C _A	DL	PART NO	C _A	DL	PART NO	C _A	DL
25	1	1	-1616								T6375-1616	87	90			
25	1	1.1/4	-1620								T6375-1620	87	100			
31	1.1/4	1	-2016								T6375-2016	129	115			
31	1.1/4	1.1/4	-2020								T6375-2020	131	120	T6936-2020	120	125
31	1.1/4	1.1/2	-2024								T6375-2024	131	120			
38	1.1/2	1.1/4	-2420								T6375-2420	136	130			
38	1.1/2	1.1/2	-2424		T6916-2424	182	131				T6375-2424	138	140			
38	1.1/2	2	-2432		T6916-2432	177	138				T6375-2432	138	160			
51	2	1.1/2	-3224								T6375-3224	160	175			
51	2	2	-3232					T6918-3232			T6375-3232	162	180	T6936-3232		

RYCO CODE 62K FLANGE COUPLINGS

RYCO T6000 Series Hose Couplings with RYCO Code 62K Flange ends are used on heavy mining equipment. They utilise a One-Piece Non-Skive design with a RYCO Code 62K Flange. The RYCO Code 62K Flange has the same Outside Diameter and O Ring groove dimensions as SAE Code 62, with a different shape at the rear of the flange. RYCO Code 62K Flanges have a long taper at the back of the Flange Head for the Flange Clamp. The S142H Flange Clamp is a one-piece heavy block style that clamps the long taper of the Flange Head.

IMPROVED DESIGN

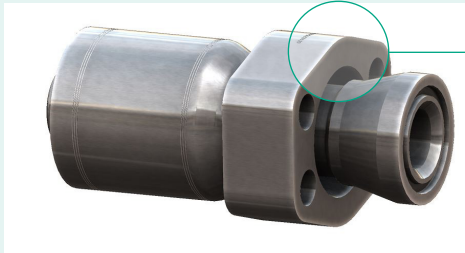

RYCO Code 62K Flange connections comprise of a **Super Strong Solid Conical Flange** mated with a **One-Piece Heavy Duty Solid Clamp** for superior performance.

Couplings and Flanges are made from high strength materials for greater durability and reliability.

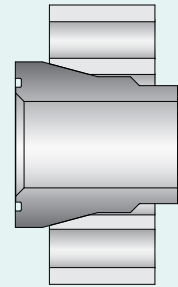

The T6000 Series Hose Coupling has an Integrated Trumpet in the ferrule that supports the hose through extreme bending and flexing during operation. When coupled with RYCO's superior H6000 series 420 bar/6100 psi hose, the T6000 Series Hose Couplings provide Increased Pulse Life and Million Cycle performance, all at a reduced Minimum Bend Radius.

- 1 Integrated support trumpet provides graduated tube compression and eliminates effects of hose twist
- 2 Controlled wire grip (waveform) and tube sealing
- 3 Tough locking tooth traps hose for positive retention
- 4 Strong, Heavy-Duty connection

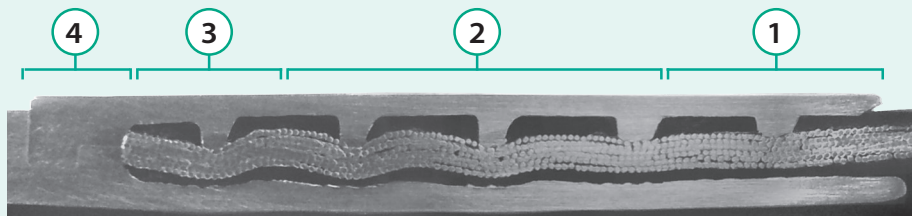

BUILT IN PARTNERSHIP

Developed specifically for the mining industry in collaboration with leading providers of heavy equipment, the RYCO Code 62K Flange products deliver:

- **Super Strong Solid Conical Flange with heavy duty solid clamp**
- **New ferrule design with integrated trumpet**
- **1 Million cycle performance at reduced bend radius**